

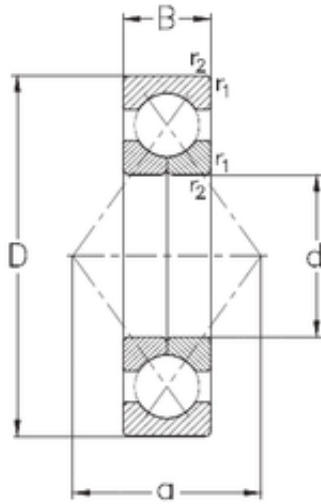

FAG BEARING LIMITED



30 mm x 62 mm x 16 mm NKE QJ206-MPA
angular contact ball bearings

Bearing No. QJ206-MPA

Size	30x62x16 mm
Bore Diameter	30 mm
Outer Diameter	62 mm
Width	16 mm
d	30 mm
D	62 mm
B	16 mm
C	16 mm
a	32 mm
r1 min.	1 mm
r2 min.	1 mm
Weight	0,3 Kg
Basic dynamic load rating (C)	40,3 kN
Basic static load rating (C0)	30 kN

QJ206-MPA Bearing 2D drawings and 3D CAD models